

|     |            |      |      |
|-----|------------|------|------|
| REV | ECN NO.    | APP. | DATE |
| A   | NEW DESIGN |      |      |
|     |            |      |      |
|     |            |      |      |

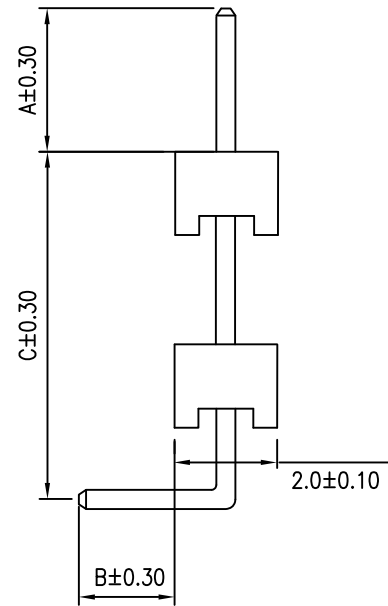
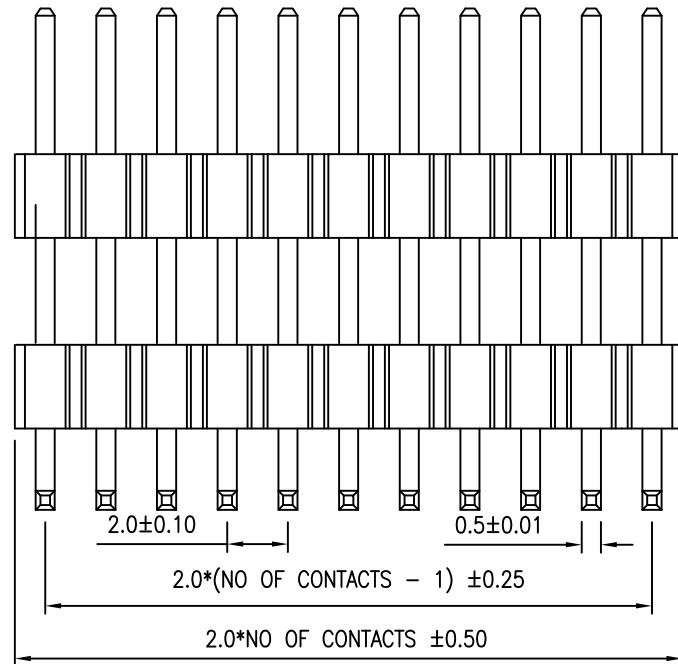

SPECIFICATION

- \* Current Rating: 2 A
- \* Withstanding Voltage: 500 VAC ( 1 min. )
- \* Insulation Resistance: 1000 Megohms MIN.
- \* Contact Resistance: 30 Milliohms MAX.
- \* Operating Temperature: -40°C to +105°C

ORDER INFORMATION

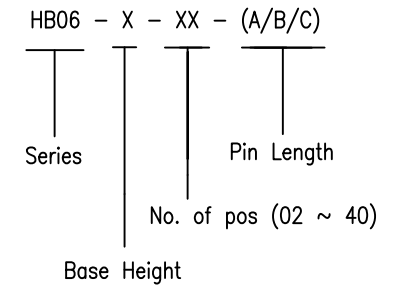

MATERIAL

- \* Contact: Brass  
0.50mm square post
- \* Insulator: PA6T & 30% G.F.
- \* Plating: All Gold

Pin Chart

| Pin | A   | B   | C   |
|-----|-----|-----|-----|
| 1   | 3.5 | 2.5 | 7.5 |
| 2   |     |     |     |
| 3   |     |     |     |
| 4   |     |     |     |

Base Height

| Base | H   |
|------|-----|
| 1    | 2.0 |
| 2    | 1.5 |
| 3    | 1.0 |
| 4    |     |

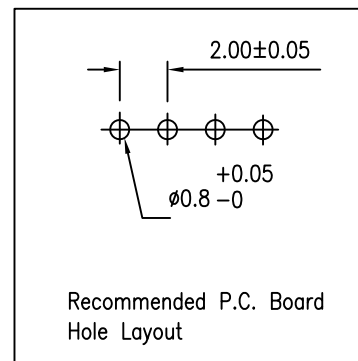

(주)신화테크 SHINHWA TECH CO.,LTD  
TEL : 031-451-9441 FAX : 031-451-9444

|        |          |   |          |
|--------|----------|---|----------|
| 0.0±   | SCALE:   | TITLE:  | PART NO: |
| 0.00±  | UNIT: MM | 2.00MM Pin Header Single Row<br>Right Angle Double Base | APP BY:  |
| 0.000± |          |   | CHK BY:  |
|        |          | MATL: PA6T & 30% G.F.                                   | DR BY:   |
|        |          | DWG. NO. HB06   |          |